

NOKOMIS ISLAND PARK SHORELINE STABILIZATION

Client: Sarasota County Parks and Recreation Department



Nokomis Island is an historic spoil island that has been minimally improved for public recreation use. However, it provides an important boating, fishing and passive Bay access site near Venice Inlet. Sections of the Nokomis Island shoreline were previously part of a County-sponsored 'erosion control demonstration project', which included a ~200' terraced timber structure on the southeastern end of the island.

Although several segments of that project remain viable today, almost 20 years after installation, the timber structure has been undermined and the upland is vulnerable to erosion from boat wakes from the adjacent ICW. Sarasota County desires to preserve this unique access while simultaneously stabilizing the shoreline in the Project Area.

Coastal Tech identified a number of design alternatives for shoreline stabilization under Phase I and evaluated/discussed with the County. The following elements have been advanced by the County and further developed and permitted by Coastal Tech under Phase II:

- an interlocking concrete block mattress/revetment for 150 foot main section,
- an inter-tidal rock planter for toe-scour protection,
- a "flattened" ramp section of the concrete revetment to allow Park patrons to walk directly into the Bay to fish and kayak, .
- removal and replacement of a set of wooden stairs,
- improvement/partial retention of upland stormwater runoff, and
- creation of a wetland mitigation area.

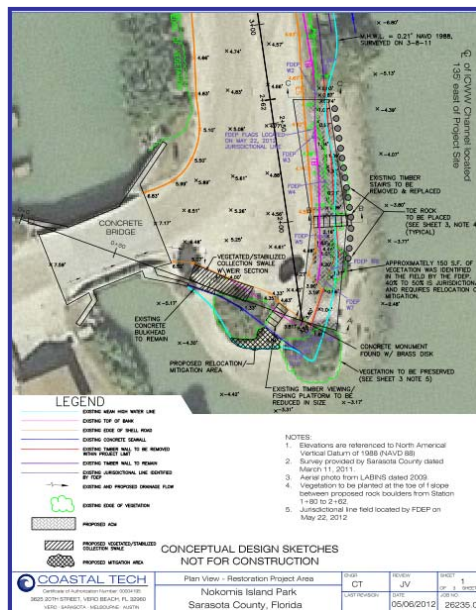

Key Elements

- Conditions Assessment
- Conceptual, Preliminary and Final Design
- Permitting
- Construction Phase Services

Date: 2010-2013

Fees: \$70,673.

Cost: \$85,000.

Contact:

*Rob LaDue, Parks & Recreation
Beaches Supervisor
Sarasota County Parks &
Recreation*

*Phillippi Estate Park
5500 S. Tamiami Trail
Sarasota, FL 34231
(941) 316-1309*

rladue@scgov.net



Enhancing Coastal Life.